

A PORTION OF THE NE 1/4 OF SECTION 9, TWP 30 N, RGE 1 W, WM

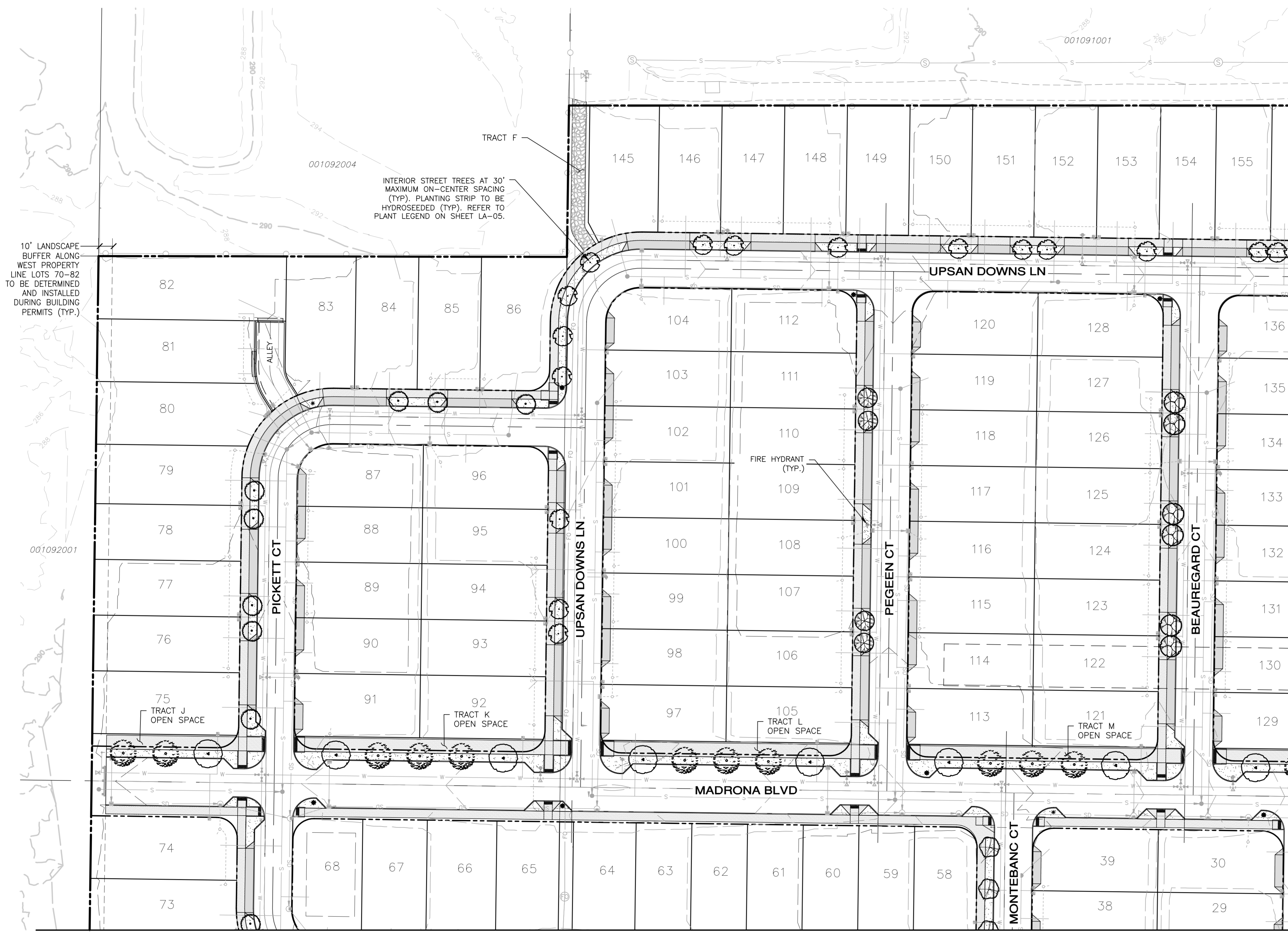

SEE SHEET LA-03 FOR CONTINUATION

SEE SHEET LA-02 FOR CONTINUATION

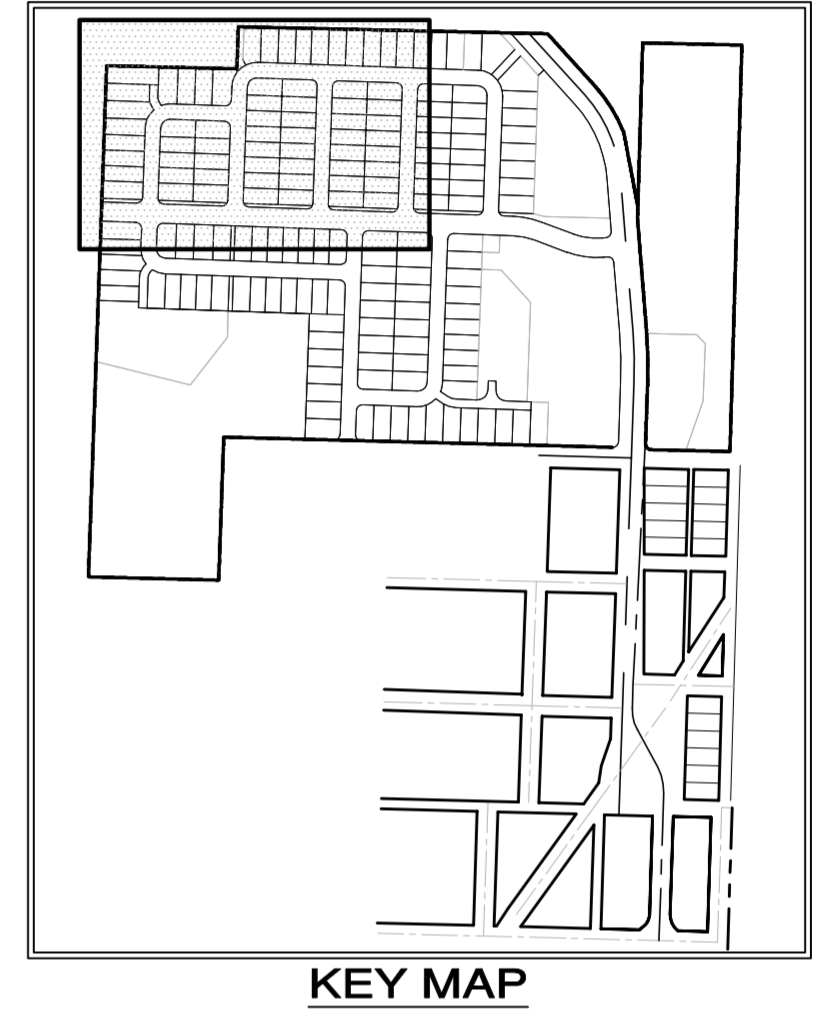
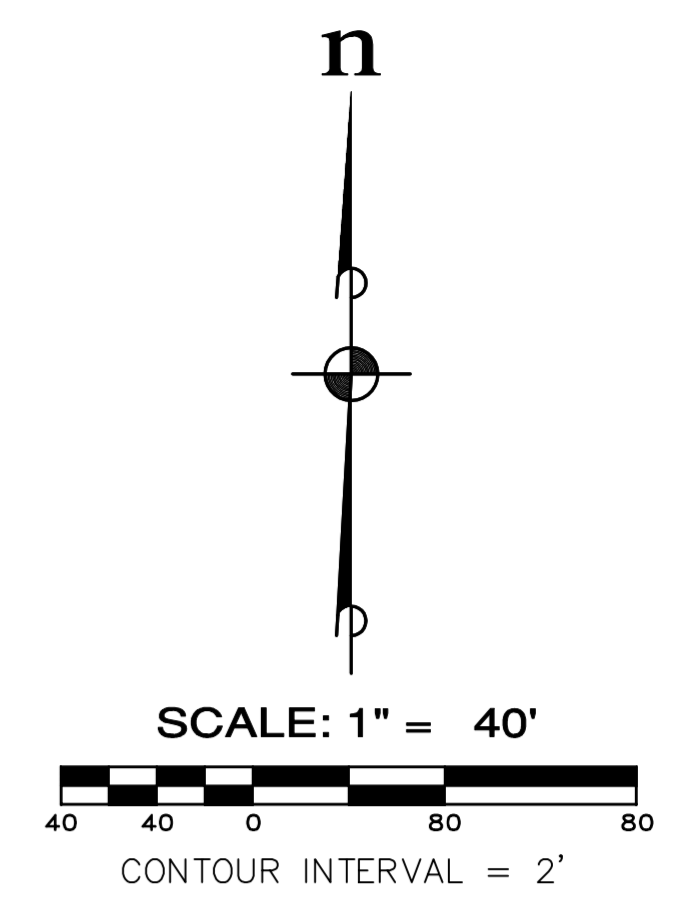

REVISIONS		
NO.	DESCRIPTION/DATE	BY

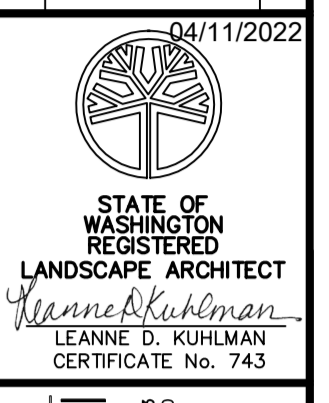

ESM CONSULTING ENGINEERS LLC
33400 8th Ave S, Suite 205
Federal Way, WA 98003
www.esmcivil.com
Civil Engineering
Public Works

FEDERAL WAY
EVERETT

(206) 838-6113
(425) 297-9900

Land Planning
Landscape Architecture

Land Surveying
Project Management

MONTEBANC MANAGEMENT, LLC
MADRONA RIDGE PUD
LANDSCAPE PLAN
PORT TOWNSEND
WASHINGTON

JOB NO.:	2090-003-021
DWG. NAME:	LA-01
DESIGNED BY:	LDK
DRAWN BY:	LDK
CHECKED BY:	
DATE:	4/08/2022
DATE OF PRINT:	
LA-01	
1 of 5 SHEETS	



File: \\esmb\ENGR\ESM-JOBS\2090\003\021\plots\LA-01.dwg
Plotted: 4/10/2022 2:29 PM
Plotted By: Leanne Kuhlman

A PORTION OF THE NE 1/4 OF SECTION 9, TWP 30 N, RGE 1 W, WM

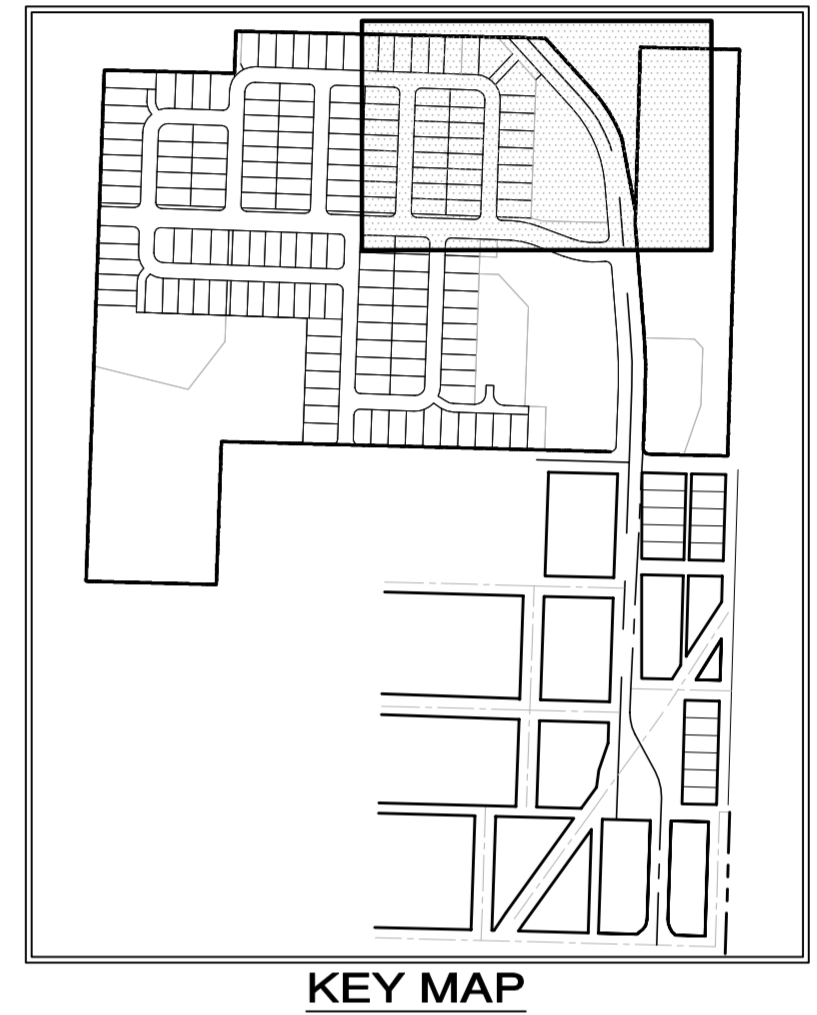
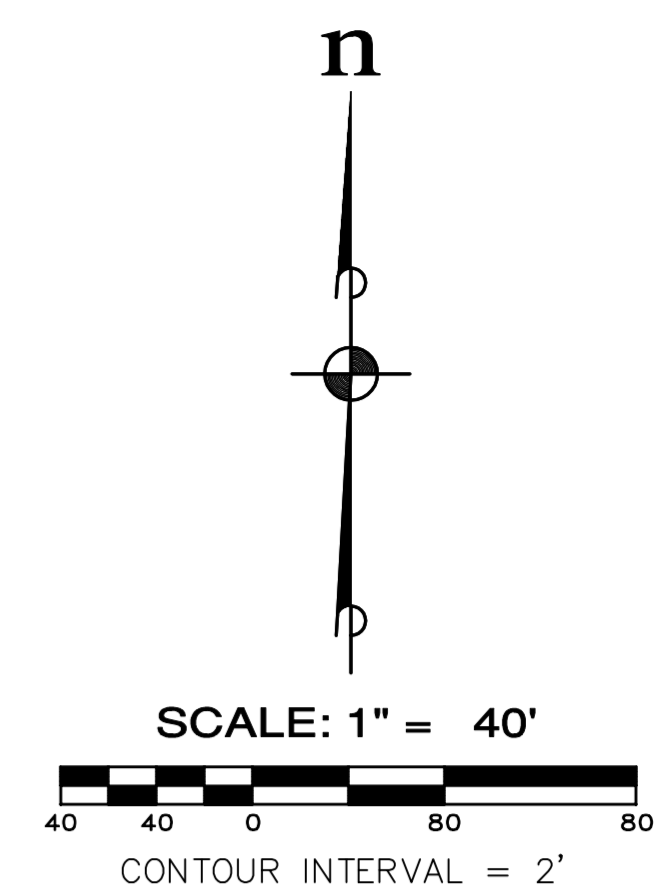
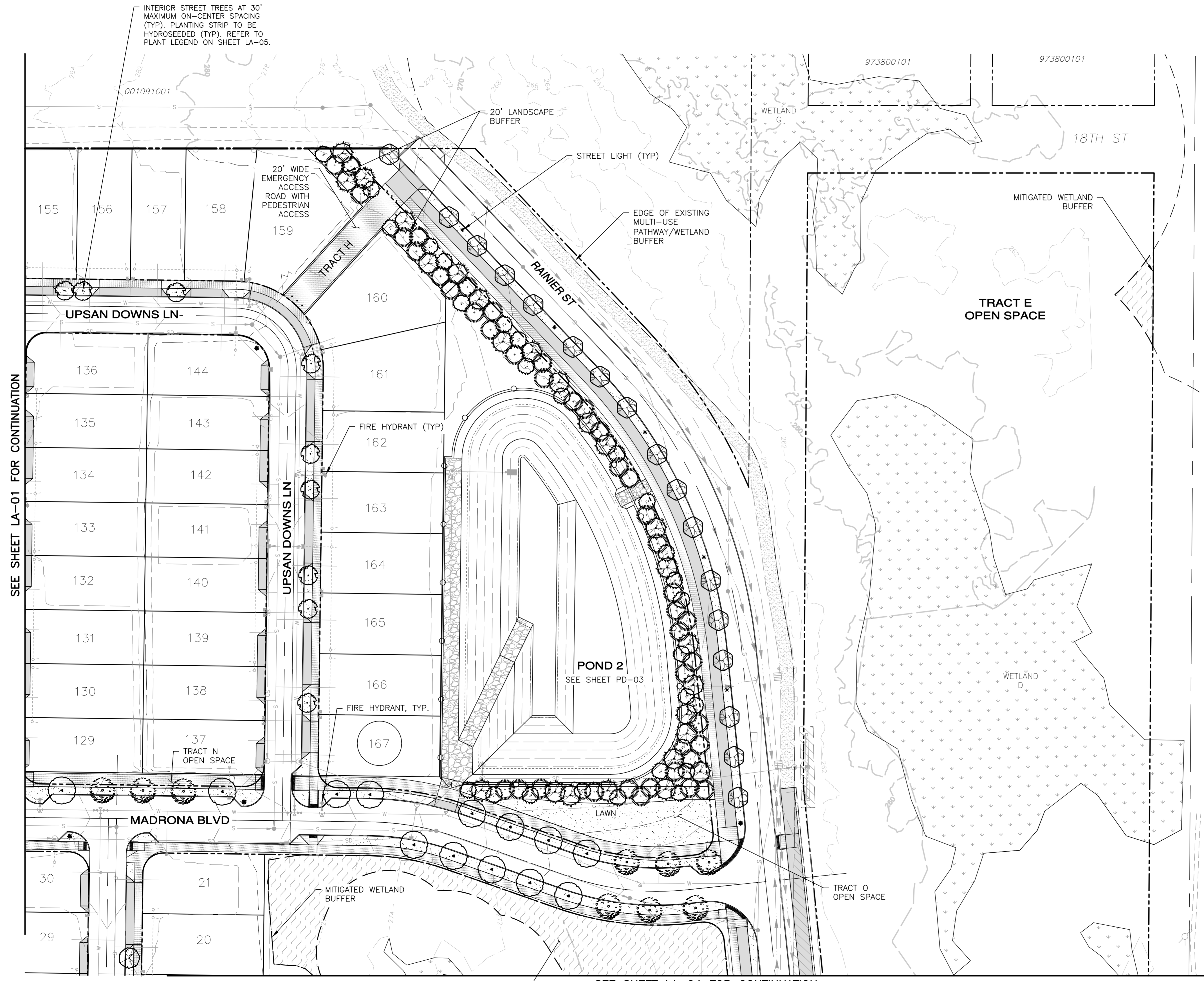

SEE SHEET LA-01 FOR CONTINUATION

SEE SHEET LA-04 FOR CONTINUATION

File: \\esmb\ENGR\ESM-JOBS\2090\003\021\plots\LA-02.dwg
Plotted: 4/10/2022 2:27 PM
Plotted By: Leanne Kuhlman

REVISIONS		
NO.	DESCRIPTION/DATE	BY

04/11/2022

STATE OF WASHINGTON REGISTERED LANDSCAPE ARCHITECT

Leanne D. Kuhlman

LEANNE D. KUHLMAN
CERTIFICATE No. 743

ESM CONSULTING ENGINEERS LLC
33400 8th Ave S, Suite 205
Federal Way, WA 98003

FEDERAL WAY
EVERETT

(206) 838-6113
(425) 297-9900

Land Planning
Landscape Architecture

www.esmcivil.com

Civil Engineering
Public Works

Land Surveying
Project Management

MONTEBANC MANAGEMENT, LLC

MADRONA RIDGE PUD

LANDSCAPE PLAN

PORT TOWNSEND

WASHINGTON

JOB NO.:	2090-003-021
DWG. NAME:	LA-02
DESIGNED BY:	LDK
DRAWN BY:	LDK
CHECKED BY:	
DATE:	4/08/2022
DATE OF PRINT:	



Know what's below.
Call before you dig.

A PORTION OF THE NE 1/4 OF SECTION 9, TWP 30 N, RGE 1 W, WM

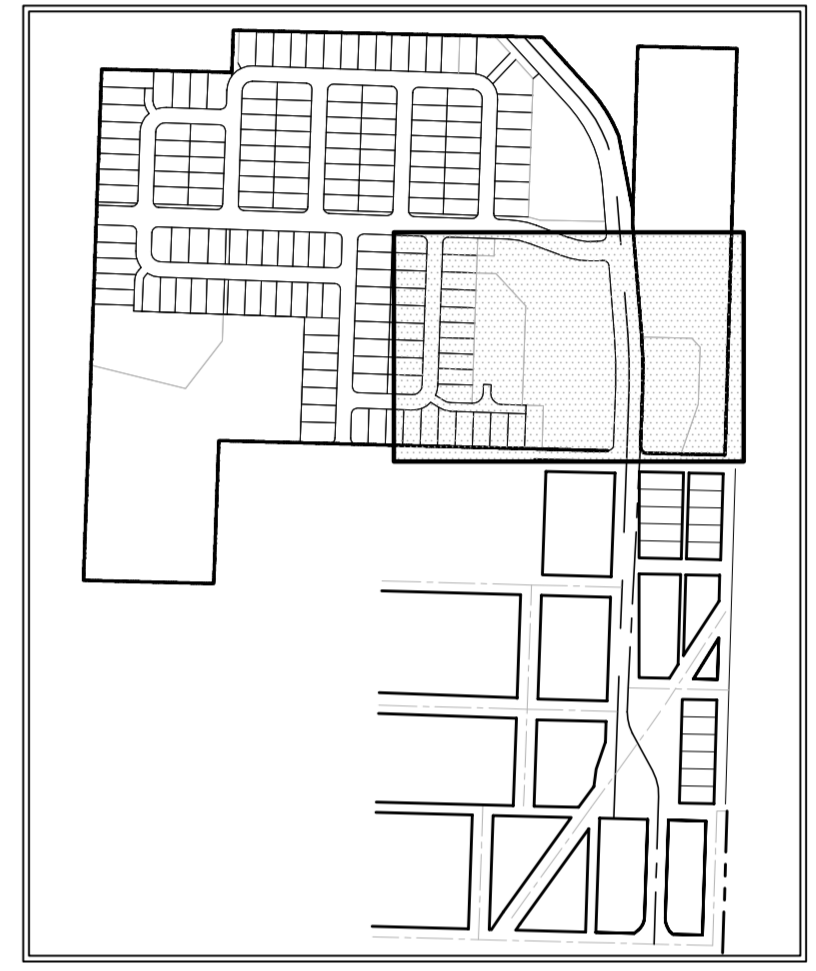
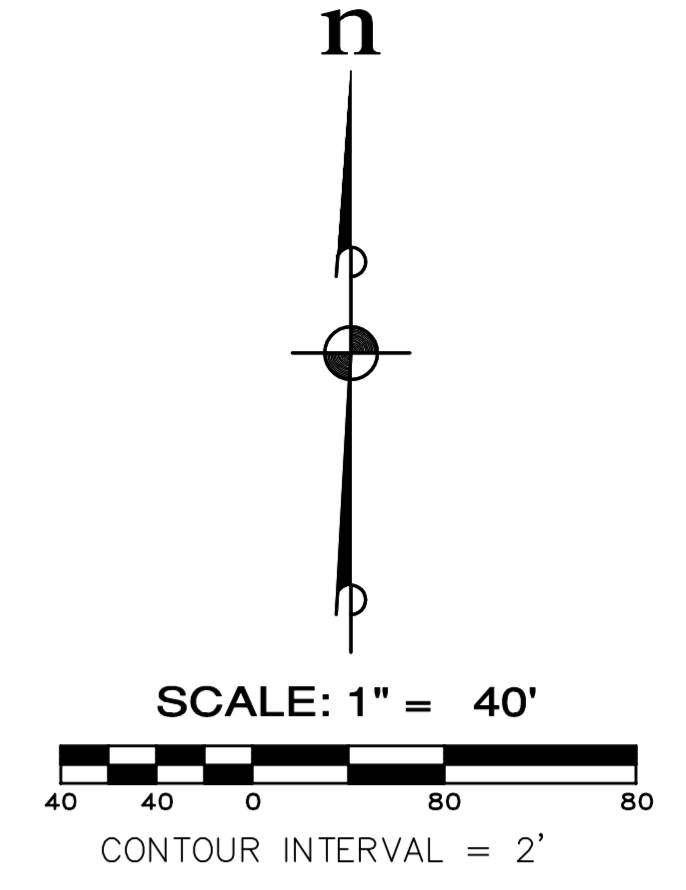
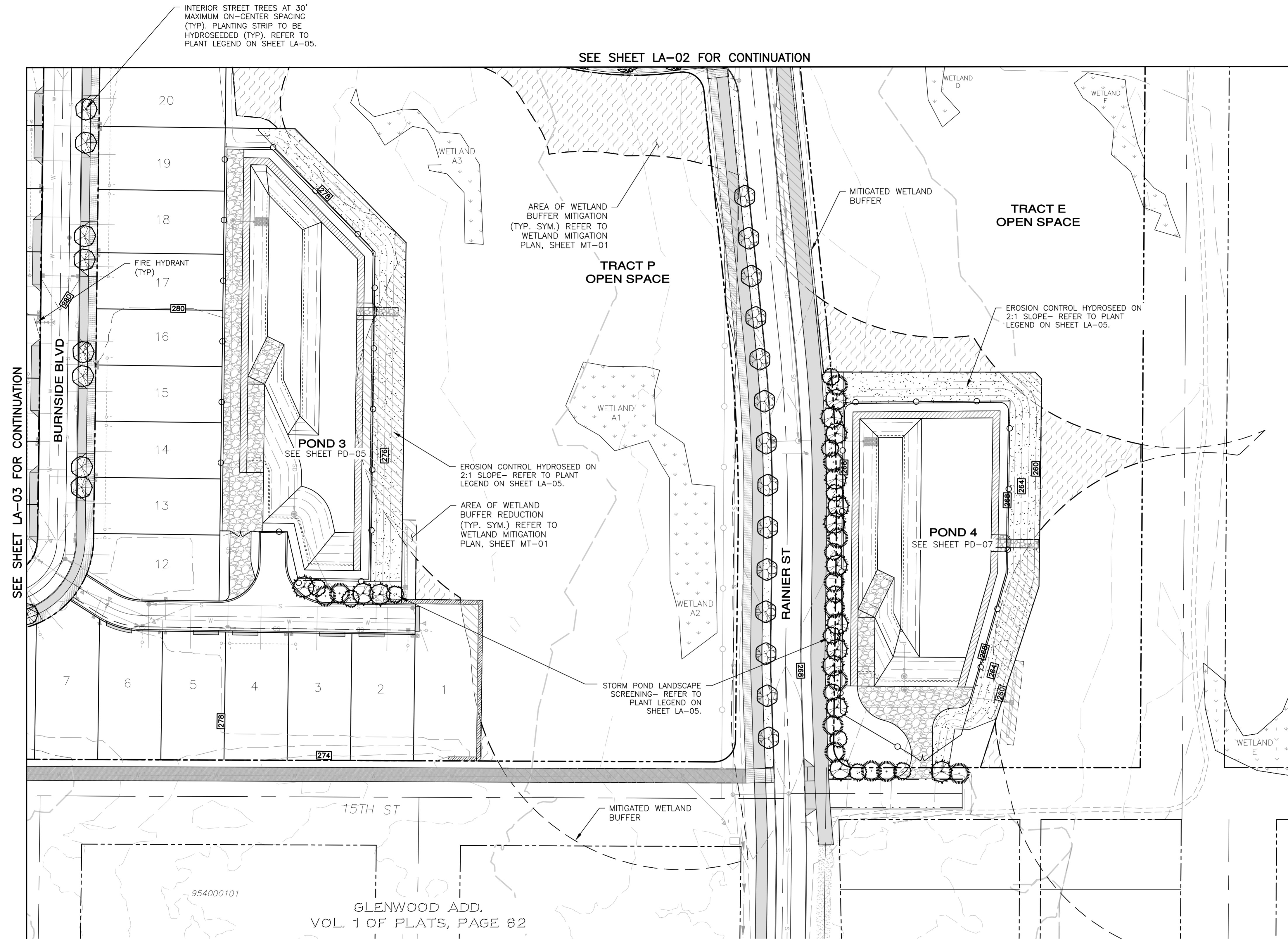

REVISIONS		
NO.	DESCRIPTION/DATE	BY

STATE OF WASHINGTON REGISTERED LANDSCAPE ARCHITECT
 LEANNE D. KUHLMAN
 CERTIFICATE No. 743

ESM CONSULTING ENGINEERS LLC
 33400 8th Ave S, Suite 205
 Federal Way, WA 98003
 FEDERAL WAY (253) 838-6113
 EVERETT (425) 297-9900
 www.esmcivil.com
 Civil Engineering Land Surveying
 Public Works Project Management
 Land Planning Landscape Architecture

MONTEBANC MANAGEMENT, LLC
 MADRONA RIDGE PUD
 LANDSCAPE PLAN
 PORT TOWNSEND WASHINGTON

JOB NO.: 2090-003-021
 DWG. NAME: LA-04
 DESIGNED BY: LDK
 DRAWN BY: LDK
 CHECKED BY:
 DATE: 4/08/2022
 DATE OF PRINT:

LA-04
 4 of 5 SHEETS



File: \\esmb\ENGR\ESM-JOBS\2090\003\021\plots\LA-04.dwg
 Plotted: 4/10/2022 2:16 PM
 Plotted By: Leanne Kuhlman

PLANT LEGEND - SPECIES SELECTION SUBJECT TO CITY APPROVAL

SYMBOL	BOTANICAL / COMMON NAME	QUANTITY	SIZE	COMMENTS
	Magnolia x loebneri 'Merrill' / MERRILL MAGNOLIA	20	2 1/2" CAL.	B4B, VIGOROUS, MATCHED
	Acer rubrum 'Armstrong' / ARMSTRONG MAPLE	20	2 1/2" CAL.	
	Nyssa sylvatica 'Wildfire' / TUPELO	6	2 1/2" CAL.	
	Halesia tetraptera / CAROLINA SILVERBELL	23	2 1/2" CAL.	
	Styrax japonicus / JAPANESE SNOUBELL	4	2 1/2" CAL.	
	Fyrus calleryana 'Cleveland Select' / FLOWERING PEAR	31	2 1/2" CAL.	
	Cornus kousa x nuttallii 'Starlight' / STARLIGHT DOGWOOD	20	2 1/2" CAL.	
	Crataegus x lavallei / LAVALLE HAUTHORN	11	2 1/2" CAL.	
	Ginkgo biloba 'Princeton Sentry' / MAIDENHAIR TREE	13	2 1/2" CAL.	
	Acer circinatum / VINE MAPLE	40	3 STEM MIN. 6' MIN. HT.	B4B, FIELD GROWN IN SUNNY CONDITIONS
	Thuja plicata 'Virescens' / WESTERN RED CEDAR	41	6' MIN. HT.	B4B
	Calocedrus decurrens / INCENSE CEDAR	54	6' MIN. HT.	B4B

Hydroseeded lawn
Erosion Control Hydroseed Mix- See specification this sheet

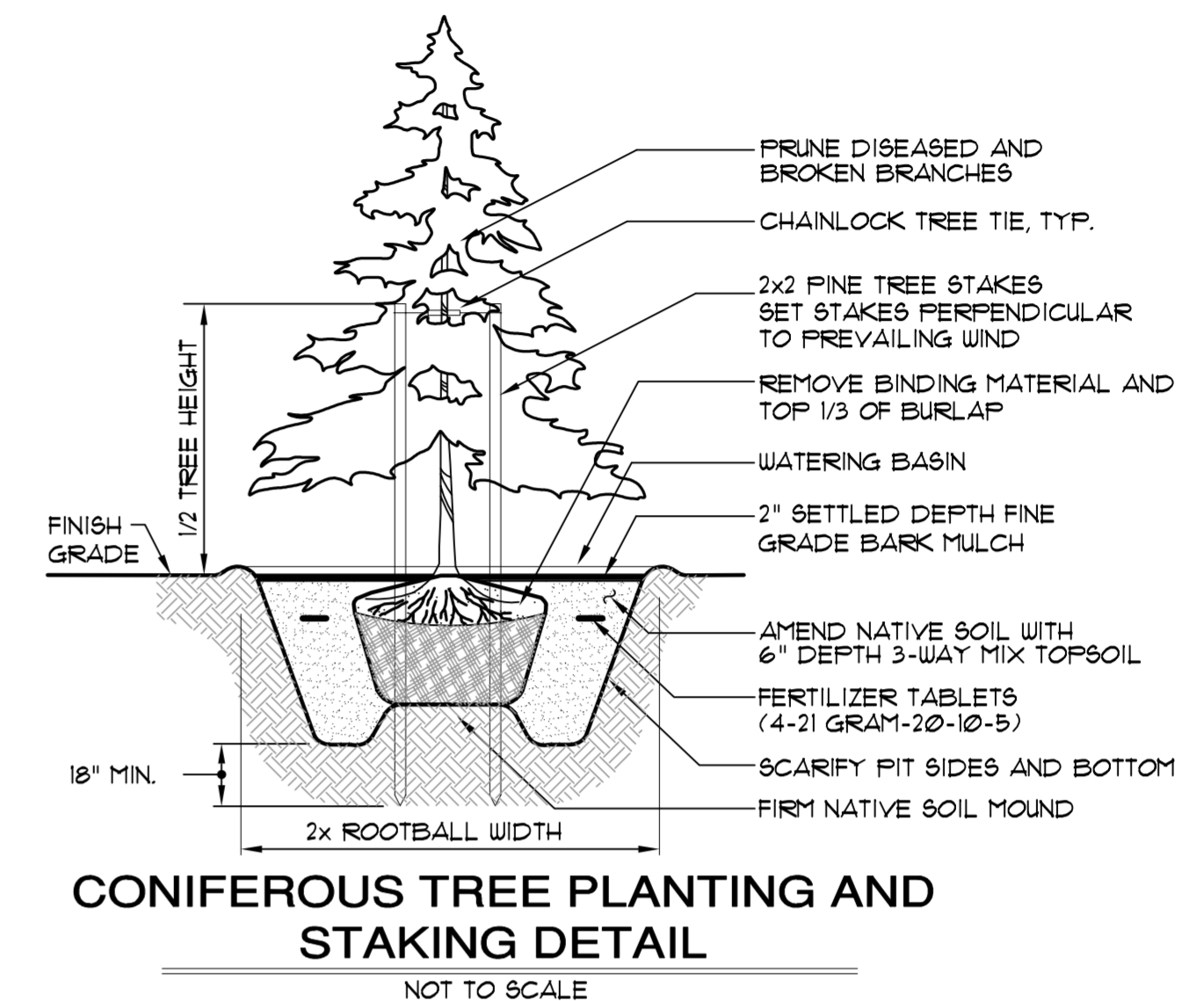
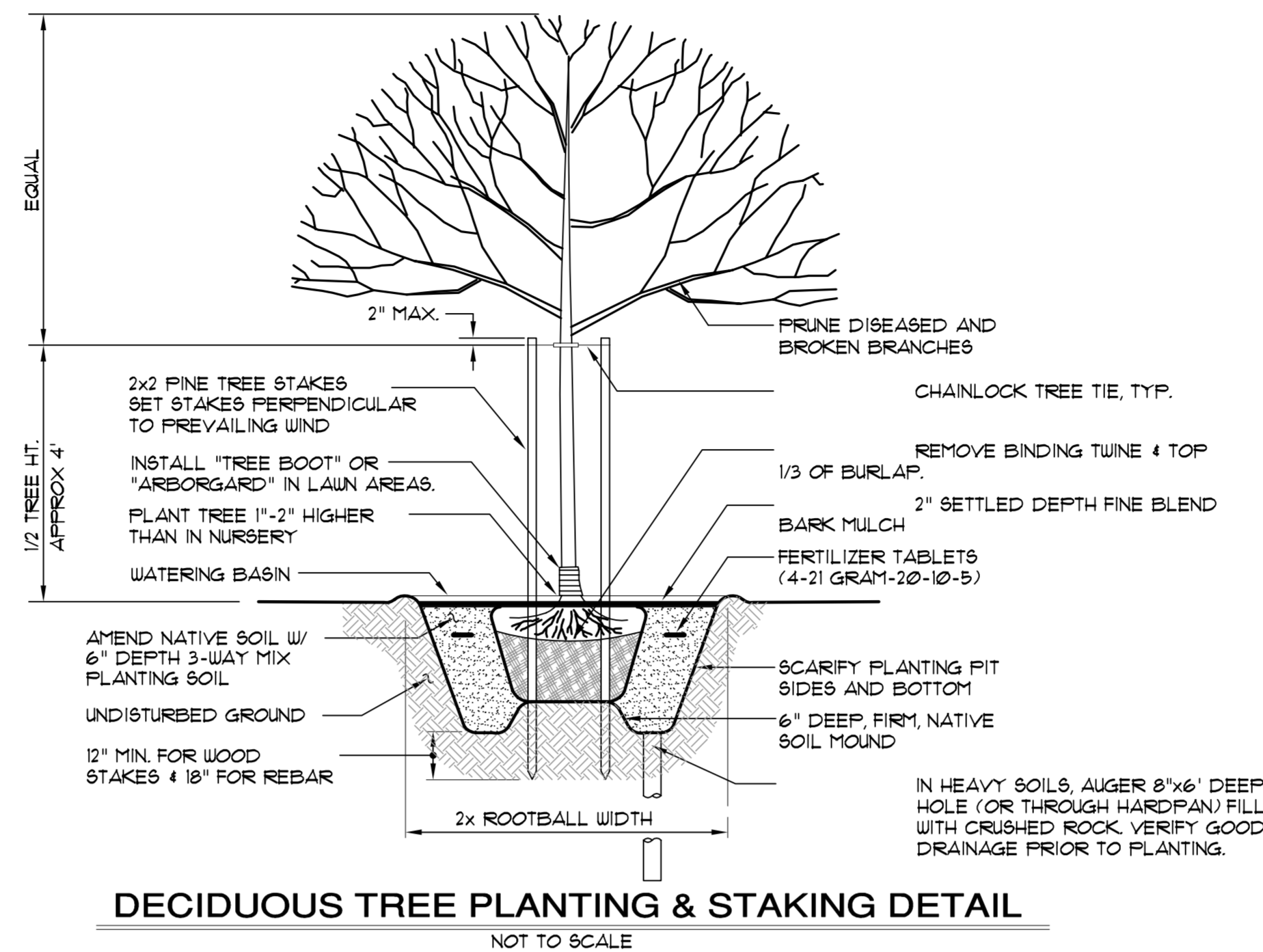

LANDSCAPE NOTES

- DO NOT DIG BEFORE LOCATING UTILITIES.
- SUBGRADES, INCLUDING BERMS, TO WITHIN 1/10TH FOOT PROVIDED BY GENERAL CONTRACTOR UNLESS OTHERWISE NOTED.
- SUBGRADE SHALL BE SCARIFIED OR ROTOTILLED IF CONDITIONS REQUIRE.
- APPLY 6" DEPTH TYPICAL 3-WAY MIX TOPSOIL IN ALL PLANTING AREAS OR AS OTHERWISE NOTED.
- APPLY 2" DEPTH FINE GRADE BARK MULCH IN ALL PLANTING AREAS. MULCH TO BE FREE OF WEED SEED, SAWDUST, RESIN OR TANNIN AND SHALL NOT CONTAIN ANY COMPOUNDS DETRIMENTAL TO PLANT GROWTH.
- CONTRACTOR IS RESPONSIBLE FOR BRINGING ANY PROPOSED SUBSTITUTIONS OR UNFORESEEN FIELD CONDITIONS TO THE ATTENTION OF THE LANDSCAPE ARCHITECT.
- LANDSCAPE ARCHITECT MAY ADJUST PLANT QUANTITIES OR VARIETIES BASED ON AVAILABILITY OR FIELD CONDITIONS.
- ALL PLANT MATERIAL SHALL BE DISEASE FREE AND ARRIVE IN A VIGOROUS GROWING CONDITION.
- ALL PLANT MATERIAL SHALL CONFORM TO USA STANDARD FOR NURSERY STOCK, LATEST EDITION.
- ALL TREE PITS SHALL BE INSPECTED TO INSURE PROPER DRAINAGE.
- POSITIVE DRAINAGE SHALL BE MAINTAINED. MOUND PLANTING AREAS A MINIMUM OF 12" UNLESS OTHERWISE NOTED.
- CONTRACTOR AGREES TO WARRANTY AND MAINTAIN ALL PLANT MATERIAL FOR ONE FULL GROWING SEASON PAST INSTALLATION AND SHALL REPLACE DEAD PLANT MATERIAL WITHIN THAT WARRANTY / MAINTENANCE PERIOD WITH NO OBLIGATION TO THE OWNER.
- STREET TREES SHALL HAVE UNIFORM BRANCHING HEIGHT OF 5 1/2" MINIMUM ABOVE GRADE OR AS OTHERWISE NOTED.
- STREET TREE LOCATIONS ARE APPROXIMATE AND SHOULD BE ADJUSTED PER STREET LIGHT AND UTILITY LOCATIONS.
- ALL TREES SHALL BE DOUBLE STAKED AS SHOWN ON THE DETAILS. STAKES TO BE REMOVED AFTER ONE FULL GROWING SEASON. TREES THAT HAVE DIED WITHIN THE ONE YEAR WARRANTY / MAINTENANCE PERIOD SHALL BE REPLACED AND RE-STAKED PER THE DETAIL.
- LANDSCAPE CONTRACTOR SHALL MAINTAIN SITE UNTIL FINAL INSPECTION AND ACCEPTANCE BY OWNER AND REVIEWING AGENCY.

HYDROSEED ORCHARD MIX FOR ALL CUT/FILL EXPOSED SLOPES

MIXTURE BELOW SPECIFIED AS A RATIO BY WEIGHT:

NAME	PROPORTION BY WEIGHT	PERCENT PURITY	GERMINATION
'ELF' PERENNIAL RYEGRASS	60%	69	90
CREEPING RED FESCUE	30%	19.9	85
HARD FESCUE	10%	9.8	85

HYDROSEED APPLICATION RATE: 220 LBS. / ACRE
 FERTILIZER APPLICATION RATE: 435 LBS. / ACRE OF 10-20-20 N-P-K SLOW RELEASE
 WOOD FIBER MULCH APPLICATION RATE: 2,000 LBS. / ACRE
 TACKIFIER APPLICATION RATE: 40 LBS. / ACRE, J-TACK OR EQUIVALENT

NOTES

SEED ALL AREAS THAT ARE BARE GROUND AND AT LEAST 18" FROM ANY PLANTED TREE OR SHRUB.

FOR HYDROSEED, USE 1-8 LBS. OF SEED MIX PER 1,000 SQUARE FEET, APPROXIMATELY 3-10 LBS. OF 10-20-20 N-P-K FERTILIZER PER 1,000 SQUARE FEET, AND APPROXIMATELY 45-46 LBS. OF WOOD CELLULOSE FIBER MULCH PER 1,000 SQUARE FEET IN ALL AREAS TO BE SEEDED. ADD APPROXIMATELY 1 LB. OF TACKIFIER PER 1,000 SQUARE FEET FOR SLOPES AS NECESSARY.

SEEDING SEASON IS LIMITED TO MARCH 1- MAY 15 & AUGUST 15- OCTOBER 1. APPLY JUTE NETTING ON STEEP SLOPES BEFORE HYDROSEEDING APPLICATION.

SEED SHALL CONFORM TO STANDARDS FOR "CERTIFIED" GRASS SEED OR BETTER, AS OUTLINED IN USDA "RULES FOR SEED CERTIFICATION", LATEST EDITION.

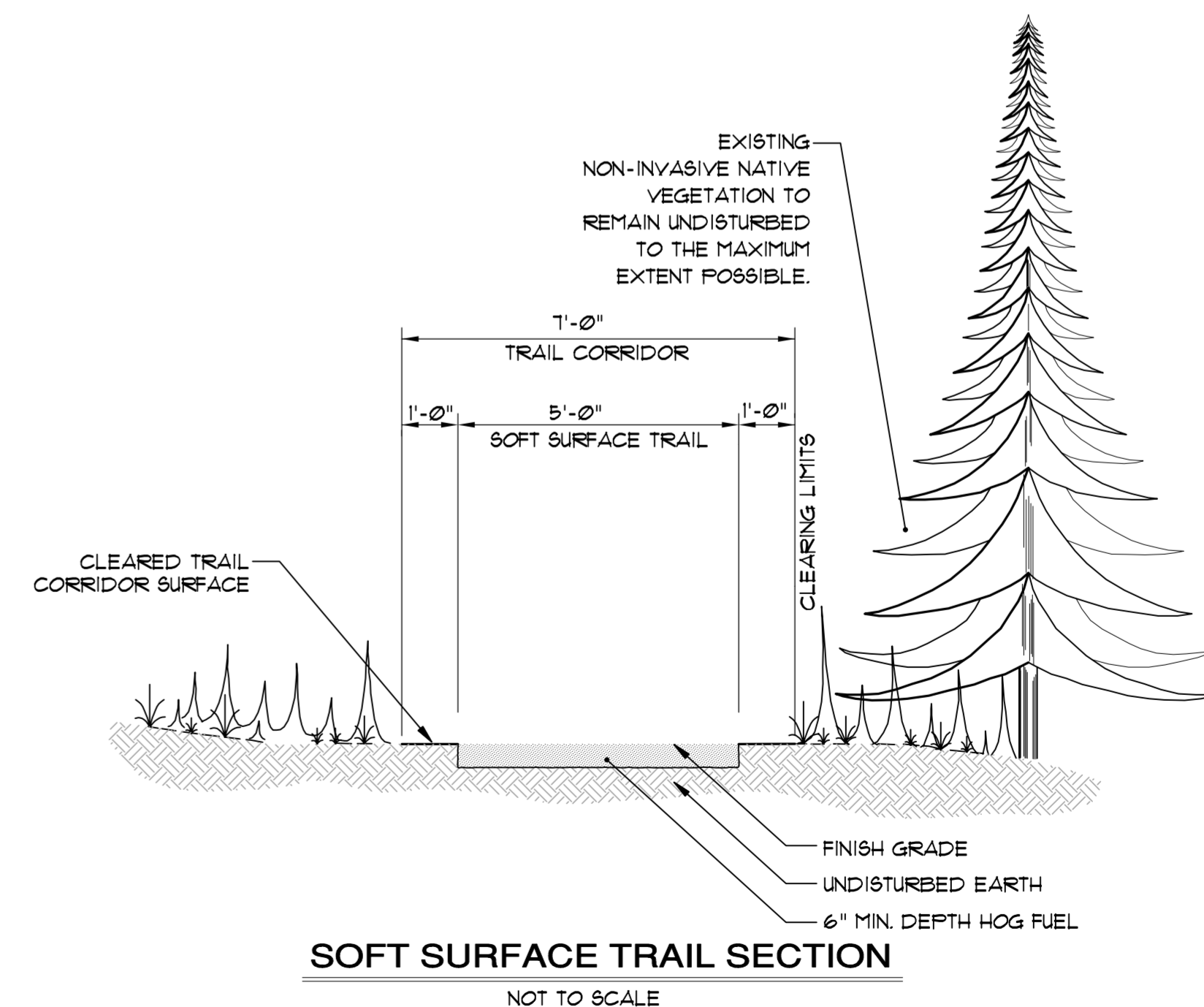

REVISIONS

NO.	DESCRIPTION/DATE	BY

04/11/2022
 STATE OF WASHINGTON REGISTERED LANDSCAPE ARCHITECT
 Leanne D. Kuhlman
 LEANNE D. KUHLMAN CERTIFICATE No. 743
 FEDERAL WAY (203) 838-6113 (425) 297-9900
 www.esmcivil.com
 Civil Engineering Land Surveying Project Management
 ESM CONSULTING ENGINEERS LLC
 33400 8th Ave S, Suite 205 Federal Way, WA 98003

MONTEBANC MANAGEMENT, LLC
 MADRONA RIDGE PUD
 LANDSCAPE PLAN DETAILS & NOTES
 PORT TOWNSEND WASHINGTON
 JOB NO.: 2090-003-021
 DWG. NAME: LA-05
 DESIGNED BY: LDK
 DRAWN BY: LDK
 CHECKED BY:
 DATE: 4/08/2022
 DATE OF PRINT:
LA-05
 5 of 5 SHEETS

File: \\esmb\ENGR\ESM-JOB\2090\003\021\plots\LA-05.dwg
 Plotted By: Leanne Kuhlman
 4/10/2022 2:14 PM